

Cycling is one of the most important forms of transport for modern times. The national and global shift towards everything environmental and healthy are epitomised in cycling.

Local authorities, architects, designers, commercial and industrial organisations are all changing and adapting to embrace the challenge of cycling – and each group has its own needs and ideas.

Falco has been involved in providing cycle parking solutions for many years and we have developed an unparalleled range of stands, racks, stores and shelters to suit every requirement. In this section we present the current range of distinctive racks and stands for cycle parking.

From the basic Sheffield stand through to the innovative double height FalcoLevel or even sophisticated bespoke parking systems, In addition, our equally large range of shelters and canopies (in the following section) are designed to complement the cycle parking systems shown here.

Across the range there is a great variation in form and function.

The diversity of design and style enables specifiers to find products with a design element, which will not only complement a scheme, but positively add value to any streetscape. Cycling is a positive activity in many ways - health, cost, environmental and much more - the benefits are clear! So let us help to solve your infrastructure needs with high quality cycle parking systems which are both functional and attractive and let's promote cycling within your community.

CYCLE PARKING



FALCOSUPP CYCLE LEANING
SUPPORT RAIL | 109



SHEFFIELD STANDS | 110-113



TRIANGLE STAND | 114



FALCOFAIR STAND | 115



FALCOTOASTER
RACK | 116/117



TRIANGLE-10, TRIANGLE-20 AND TRIANGLE-30 | 118/119



IDEAL 2.0 RACK | 120/121



A-11/A-11B RACK | 122/123

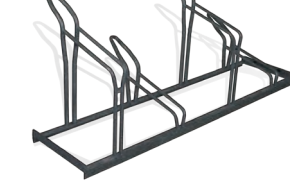

FALCOSOUND
RACK | 124/125



FALCO-DK RACK | 126/127

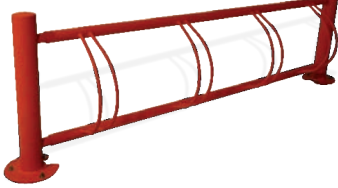

FALCOSCANDI
RACK | 126/127



FALCOHANGER | 128



FALCOTUMBLER | 129



FALCOLEVEL PREMIUM+
TWO-TIER RACK | 130-133



FALCOVERT | 134



FALCOMAT
STAND | 135



HANGING
RAIL RACK | 135



F-7 AND F-8
CLAMP | 136/137



F-1
WALL CLAMP | 138



FALCOCRATE
RACK | 139



FALCOFIX 2.0
CYCLE STATION | 140



FALCOBOOST
CYCLE PUMP | 141



FALCOSAFE
LOCKER | 142/143

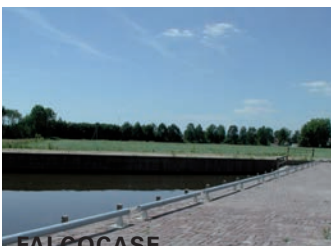

FALCOCASE
LOCKER | 144/145



FALCOSUPP CYCLE LEANING RAIL

The FalcoSupp is a convenient and easy to use leaning barrier designed to support cyclists at traffic lights and rail crossings. The simple, yet effective design features two supports, one allowing the cyclist to grasp with their hands and the other with their feet.

The FalcoSupp is an added value product designed to facilitate a cyclists journey and to stimulate the flow of traffic by encouraging the cyclist to remain seated rather than dismounting at key junctions.

The FalcoSupp reduces the chances of a fall by encouraging cyclists to remain seated during temporary stops, this is even more important when cycling with heavier e-bikes.

FALCOSUPP	
PART CODE	DESCRIPTION
02.020.000*	below ground fix, 3,000mm long, 1,261mm above ground height, 300mm below ground depth
02.020.060*	surface fix, 3,000mm long, 1,275mm height

*All steelwork can be powder coated in any of the 192 standard RAL colours upon request, simply add 'PC' to the start of any part code(s) listed to the left.



The FalcoSupp is an ergonomic bicycle support with an integral foot rest and friendly hand grip. Ideal for cyclists to use while waiting for the green light. By using the FalcoSupp support , cyclists can get on their bike faster.

The support has a length of 3 meters and can be used by several cyclists at one time. Following research throughout European cycling countries, FalcoSupp has been designed to deliver excellent ergonomics and a very user-friendly cycling experience.

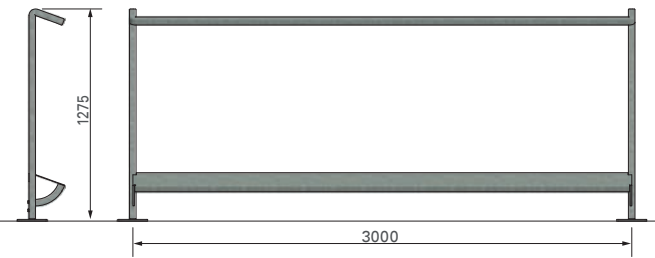

FalcoSupp, part code 02.020.060



SHEFFIELD STANDS

Sheffield stands are the most fundamental of cycle parking products. Two cycles can be secured, one on either side with a chain or cable lock. They are available with base plates for surface mounting or with longer legs for below ground fixing into concrete.

Additionally there are options with or without a cross strut, as well as in different diameter tubes.

Normally placed at 800mm intervals, Sheffield stands are a sound, friendly and affordable bicycle parking solution. All Falco stands are hot dip galvanised to BS EN ISO 1461 and additionally can be powder coated.

The stands are available with base plates for surface fix or with an extended tube for below ground fix. Available in Ø41.5mm, Ø47.5mm and Ø60.0mm.



Falco also offers the Sheffield stands in stainless steel with or without cross-struts. Available in Ø48.3mm.



STAINLESS STEEL SHEFFIELD STANDS

SHEFFIELD STANDS				
PART CODE	Ø DIAM.	WIDTH	HEIGHT	FIX
02.008.000	41.5mm	900 mm	1,100mm	below ground fix
02.008.015	41.5mm	900 mm	800mm	base plates
02.520.000	47.5mm	900 mm	1,250mm	below ground fix
02.520.010	47.5mm	900 mm	900mm	base plates
02.521.000	47.5mm	1,200 mm	1,250mm	below ground fix
02.522.010	47.5mm	1,200 mm	900mm	base plates
02.522.000	47.5mm	1,500 mm	1,250mm	below ground fix
02.521.010	47.5mm	1,500 mm	900mm	base plates
02.561.000	60.0mm	1,200 mm	1,250mm	below ground fix
02.561.010	60.0mm	1,200 mm	900mm	base plates
02.562.000	60.0mm	1,500 mm	1,250mm	below ground fix
02.562.010	60.0mm	1,500 mm	900mm	base plates

SHEFFIELD STANDS (STAINLESS STEEL)				
PART CODE	DIAMETER Ø	WIDTH	HEIGHT	
05.240.000	48.3mm	900 mm	1,250mm	below ground fix
05.240.010	48.3mm	900 mm	900mm	surface fix
05.241.000	48.3mm	1,200 mm	1,250mm	below ground fix
05.241.010	48.3mm	1,200 mm	900mm	surface fix

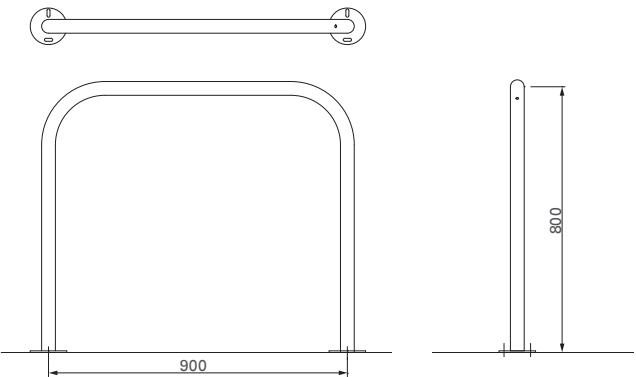

Sheffield stand (Ø41.5mm), part code 02.008.015

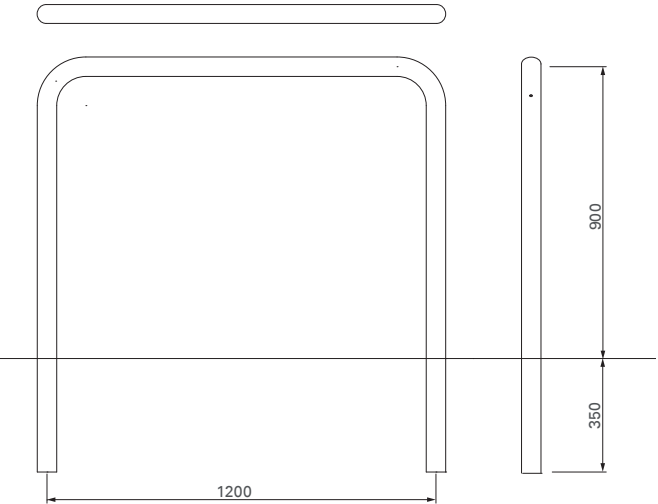

Sheffield stand (Ø60.0mm), part code 02.561.000



SHEFFIELD STAND Ø41,5 mm | 02.008.015



SHEFFIELD STANDS WITH CROSS STRUT (Ø41.5mm)

SHEFFIELD STANDS
(WITH CROSS STRUT)

Identical to the standard Sheffield stand, the cross strut is added between the two legs for added security and rigidity.

Sheffield stands are the most fundamental of cycle parking products. Two cycles can be secured, one on either side with a chain or cable lock. They are available with base plates for surface mounting or with longer legs for below ground fixing into concrete.

All Falco stands are hot dip galvanised to BS EN ISO 1461 and additionally can be powder coated in a choice of 192 standard RAL colours.

The stands are available with base plates for surface fix or with an extended tube for below ground fix. Available in Ø41.5mm, Ø47.5mm and Ø60.0mm.



Falco also offers the Sheffield stands in stainless steel with or without cross-struts. Available in Ø48.3mm.



STAINLESS STEEL SHEFFIELD STANDS

SHEFFIELD STANDS WITH CROSS STRUT				
PART CODE	Ø DIAM.	WIDTH	HEIGHT	FIX
02.010.000	41.5mm	900 mm	1,100mm	below ground fix
02.010.010	41.5mm	900 mm	900mm	base plates
02.520.000	47.5mm	900 mm	1,250mm	below ground fix
02.520.010	47.5mm	900 mm	900mm	base plates
02.521.000	47.5mm	1,200 mm	1,250mm	below ground fix
02.521.010	47.5mm	1,200 mm	900mm	base plates
02.522.000	47.5mm	1,500 mm	1,250mm	below ground fix
02.522.010	47.5mm	1,500 mm	900mm	base plates
02.551.000	60.0mm	1,200 mm	1,250mm	below ground fix
02.551.009	60.0mm	1,200 mm	900mm	base plates
02.552.000	60.0mm	1,500 mm	1,250mm	below ground fix
02.552.009	60.0mm	1,500 mm	900mm	base plates

SHEFFIELD STANDS WITH CROSS STRUT (STAINLESS STEEL)				
PART CODE	DIAMETER Ø	WIDTH	HEIGHT	
05.250.000	48.3mm	900 mm	1,250mm	below ground fix
05.250.010	48.3mm	900 mm	900mm	surface fix
05.251.000	48.3mm	1,200 mm	1,250mm	below ground fix
05.251.010	48.3mm	1,200 mm	900mm	surface fix

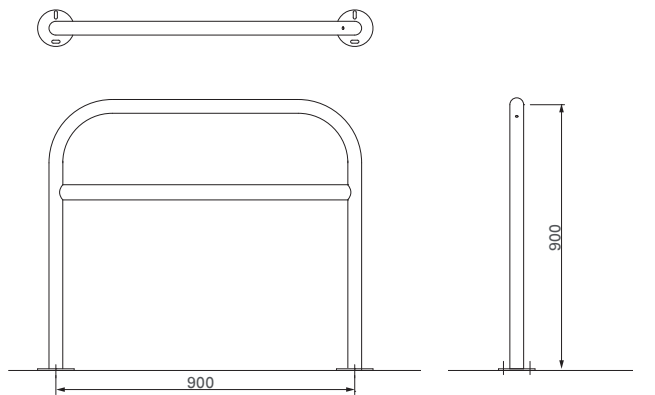

Sheffield stand (Ø41.5mm), part code 02.010.010

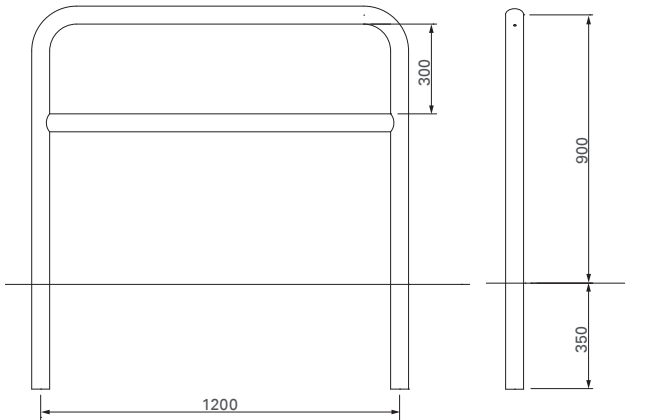

Sheffield stand (Ø60.0mm), part code 02.551.000



SHEFFIELD WITH CROSS STRUT | 02.010.000



TRIANGLE CYCLE STANDS AND TRIANGLE CYCLE CANOPY <page 174/175>

TRIANGLE CYCLE STAND

A great design led alternative to the Sheffield stand, the fin shaped cycle stand is part of our ‘Triangle’ range of co-ordinated street furniture <page 14/15>.The design is very user friendly in that it gives all sizes of bicycles something to lean against. The main tube of the stand is Ø60.3mm x 2.9mm thick steel and can be supplied with anchor parts to grout in or base plates for surface fix.

TRIANGLE CYCLE STAND	
PART CODE	DESCRIPTION
01.568.000	below ground fix
01.568.026	on baseplates (130x150x8mm)

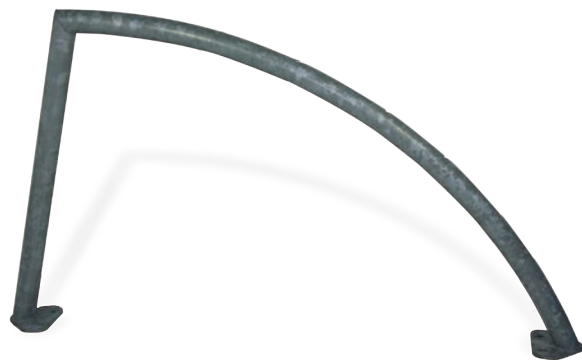

TRIANGLE CYCLE STAND | 01.568.026

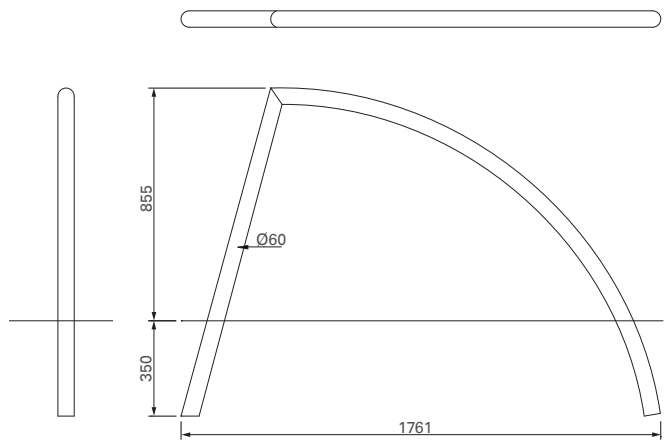

Triangle cycle stand, part code 01.568.000



FALCOFAIR CYCLE STAND

A further variation to the cycle stand/leaning bracket is the curvy FalcoFair with its Greek ‘pi’ shape. The stand is manufactured from 3 symmetrical robust steel sections welded in a curved profile. The stand is 1,024mm wide and 900mm high above ground level. It is a solid design thanks to the use of 40mm profile tube.

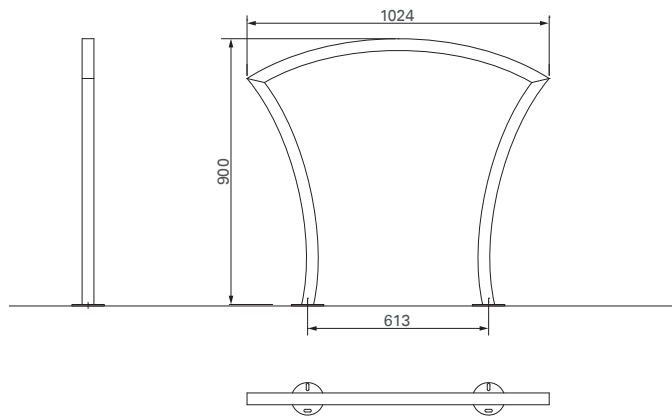

FalcoFair, part code 02.015.010

FALCOFAIR CYCLE STAND	
PART CODE	DESCRIPTION
02.015.000	total height 1,100mm, below ground fix
PC02.015.000	total height 1,100mm, powder coated in RAL ____
02.015.010	height 900mm on base plates (Ø110mm)
PC02.015.010	height 900mm on base plates (Ø110mm), powder coated in RAL ____



FALCOFAIR POWDER COATED | PC02.015.010



FALCOTOASTER RACKS IN A FALCOQUARTER CYCLE COMPOUND <page 154/155>

FALCOTOASTER CYCLE RACK

As its name suggests, the FalcoToaster, mounts rows of Sheffield stands on a purpose built frame creating a ‘toast rack’ effect. This is a great option for temporary installations or where digging up the floor is not appropriate. The range accommodates between 4 and 10 cycles with different spacing options.

The securing supports are mounted 600mm, 750mm or 800mm apart. The FalcoToaster is particularly useful for public use, as it can be used from 2 sides, is sturdy and appealing in its simplicity. The base supporting tubes have holes for mounting the FalcoToaster on a level base. The top hole is larger so that the bolt fixing is concealed within the rail.

All Falco steelwork is hot dip galvanized to BS EN ISO 1461 and can additionally be powder coated in any of the 192 RAL colours.



FALCOTOASTER | 01.245.004

FALCOTOASTER			
PART CODE	NUMBER OF SUPPORTS	CTC	LENGTH
01.245.002	2	600mm	1,200mm
01.245.003	3	600mm	1,800mm
01.245.004	4	600mm	2,400mm
01.245.005	5	600mm	3,000mm
01.245.102	2	750mm	1,500mm
01.245.103	3	750mm	2,250mm
01.245.104	4	750mm	3,000mm
01.245.105	5	800mm	4,000mm
99.000.011	aluminium coupling to join FalcoToasters		
	(2 required)		



BESPOKE FALCOTOASTER RACK, WITH LASER CUT SIDE PANELS



FALCOTOASTER | 2x 01.245.005

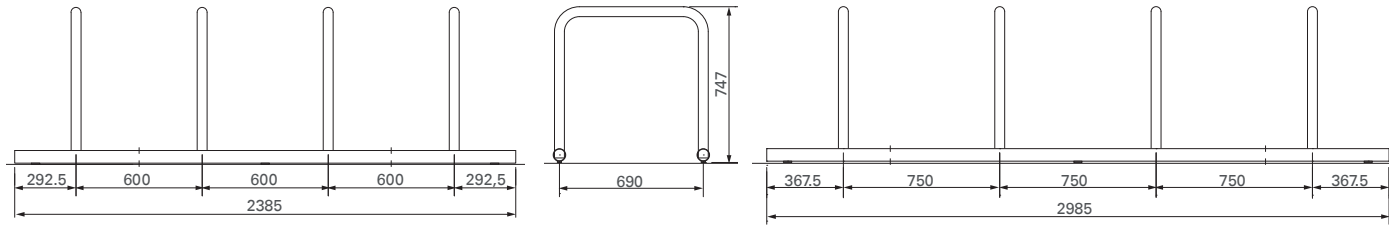
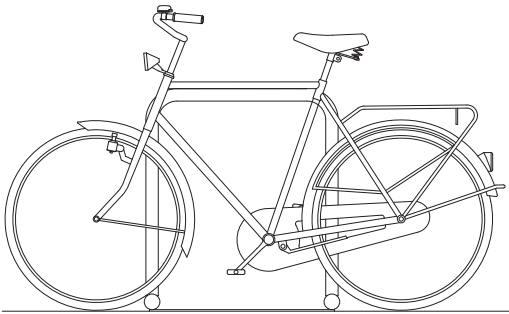

FalcoToaster, part code 01.245.004

part code 01.245.104



Photo: ipv Delft

TRIANGLE-10 CYCLE STANDS

TRIANGLE CYCLE STAND SERIES

There are three versions of the Triangle cycle stand with wheel brackets: Triangle-10, Triangle-20 and Triangle-30.

Each stand has wheel brackets integrated into the design with three general options;

- a) a single wheel low bracket on the left only.
- b) a single wheel high bracket on the right only.
- c) a single wheel low bracket on the left and a high bracket on the right.

TRIANGLE-10	
PART CODE	DESCRIPTION
01.550.000	1 low cycle space left, with anchor part
01.550.025	1 low cycle space left, with base plate
01.551.000	double-sided 2 low and 2 high, with anchor part
01.551.025	double-sided 2 low and 2 high, with base plate
01.553.000	1 high cycle space right, with anchor part
01.553.025	1 high cycle space right, with base plate
01.554.000	1 high and 1 low cycle space, with anchor part
01.554.025	1 high and 1 low cycle space, with baseplate

TRIANGLE-10 CYCLE STAND

Has recognisable triangle design wheel clamps with a single central support and individual locking eyes. Also available in a double-sided design with 4 spaces.



TRIANGLE-10 | PC01.554.000

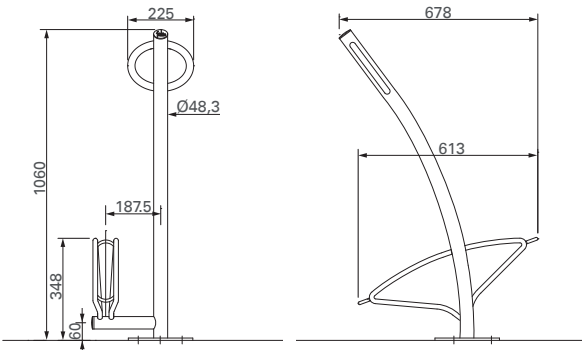

Triangle-10, part code 01.550.025

The Triangle range of cycle stands offer a real design-led cycle parking option to encourage the use of cycling.



TRIANGLE-20 | PC01.559.000

TRIANGLE-20 CYCLE STAND

Has recognisable triangle design wheel clamps with a dual central support creating a large single locking eye. Also available in a double sided design with 4 spaces (upon request).

TRIANGLE-20	
PART CODE	DESCRIPTION
01.555.000	1 low cycle space left, with anchor part
01.555.025	1 low cycle space left, with baseplate
01.558.000	1 high cycle space right, with anchor part
01.558.025	1 high cycle space right, with baseplate
01.559.000	1 high and 1 low cycle space, with anchor part
01.559.025	1 high and 1 low cycle space, with baseplate

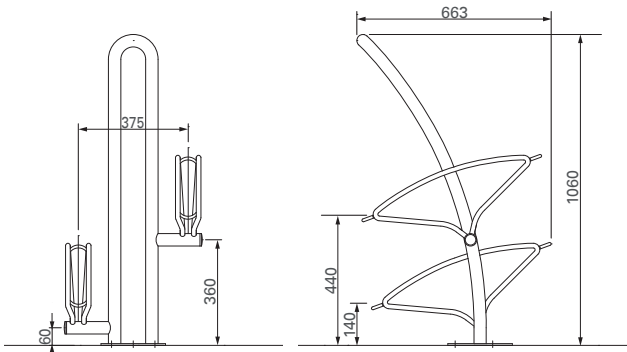

Triangle-20, part code 01.559.025

All of the Triangle cycle stand products are hot-dip galvanised and can be polyester powder-coated in any of the 192 standard RAL colours.



TRIANGLE-30 | 01.564.026

TRIANGLE-30 CYCLE STAND

Has recognisable triangle design wheel clamps with a ‘fin’ Sheffield stand support. The model is also available without wheel brackets <page 116>.

TRIANGLE-30	
PART CODE	DESCRIPTION
01.560.000	1 low cycle space left, with anchor parts
01.560.026	1 low cycle space left, with baseplates
01.563.000	1 high cycle space right, with anchor parts
01.563.026	1 high cycle space right, with baseplates
01.564.000	1 high and 1 low cycle space, with anchor parts
01.564.026	1 high and 1 low cycle space, with baseplates

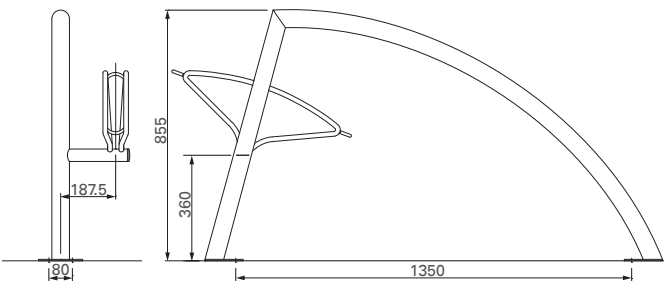

Triangle-30, part code 01.563.026



IDEAL 2.0 SINGLE-SIDED CYCLE RACK

IDEAL 2.0 CYCLE RACK

The Ideal 2.0 cycle rack features an enhanced aesthetic design, accomodates wider tyres and is even easier to maintain than the original Ideal rack!

As with all Falco products, the Ideal 2.0 is exceptionally robust, user-friendly and functional.

The Ideal 2.0 is the successor to the standard Ideal rack accommodating wider tyres and with an enhanced aesthetic design. The Ideal 2.0 has a centre to centre distance of 400mm and can accommodate wider tyres due to a wider recess of each wheel support.

A locking eye provides additional security to the cyclist and a protective sleeve prevents damage to the front fork.

The enhanced cycle rack design ensures minimal accumulation of debris which is easier to clean and results in lower maintenance costs.

The cycle rack can be equipped with an addon support to act as an additional locking point. This optional support is manufactured from steel and integrated into the rack.

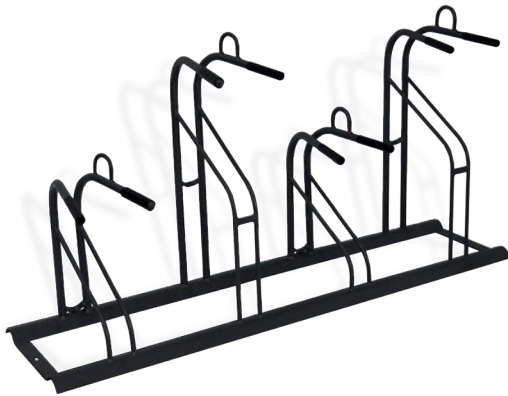

IDEAL 2.0 SINGLE SIDED | 00.804.040

IDEAL 2.0 SINGLE SIDED	
PART CODE	DESCRIPTION
00.804.040	4 place, c.t.c. 400mm, length 1,600mm
00.854.040	4 place, c.t.c. 400mm, length 1,600mm, with additional locking bars
00.805.040	5 place, c.t.c. 400mm, length 2,000mm
00.855.040	5 place, c.t.c. 400mm, length 2,000mm with additional locking bars
00.806.040	6 place, c.t.c. 400mm, length 2,400mm
00.856.040	6 place, c.t.c. 400mm, length 2,400mm, with additional locking bars

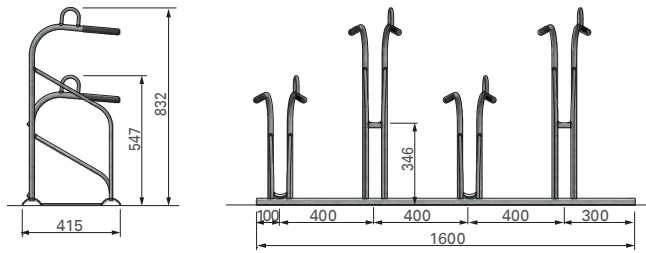

Ideal 2.0, part code 00.804.040

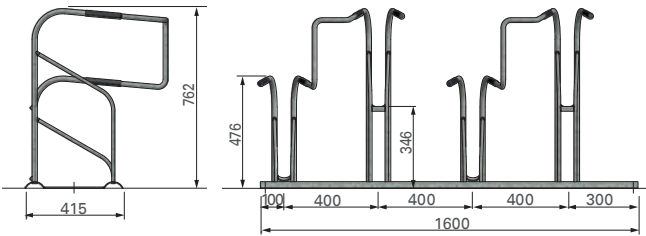

Ideal 2.0, part code 00.854.040



IDEAL 2.0 DOUBLE SIDED,
with additional locking bars | 00.878.020

IDEAL 2.0 DOUBLE SIDED	
PART CODE	DESCRIPTION
00.824.020	4 place (2x2), c.t.c. 200mm, length 800mm
00.874.020	4 place (2x2), c.t.c. 200mm, length 800mm, with additional locking bars
00.826.020	6 place (2x3), c.t.c. 200mm, length 1,200mm
00.876.020	6 place (2x3), c.t.c. 200mm, length 1,200mm, with additional locking bars
00.828.020	8 place (2x4), c.t.c. 200mm, length 1,600mm
00.878.020	8 place (2x4), c.t.c. 200mm, length 1,600mm, with additional locking bars

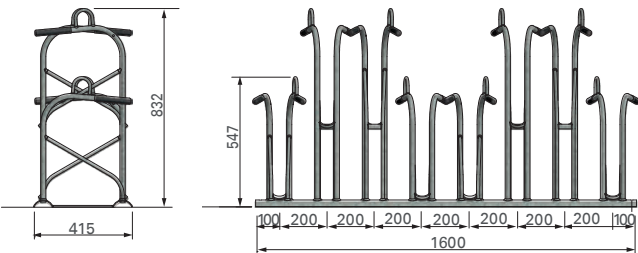

Ideal 2.0, part code 00.828.020

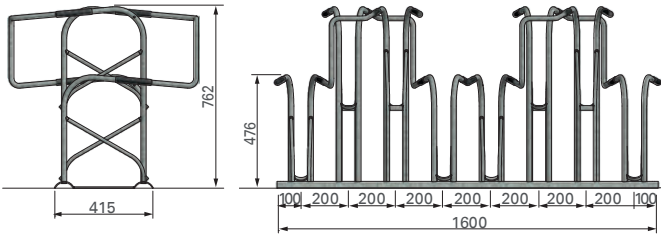

Ideal 2.0, part code 00.878.020



A-11MB CYCLE RACK | 00.006.037

A-11 CYCLE RACK

The standard A-11 rack for racing bikes is available in two variants, with spacing’s either 300mm or 375mm centres. Available as a single or double sided version.

A-11MB MOUNTAIN CYCLE RACK

The ‘MB’ version has slightly wider tube spacing’s to accommodate the larger tyres on mountain bikes. Additionally the spacing of the cycle places is increased to 400mm, to reduce the likelihood of handle bars clashing. Available as single or double sided versions.

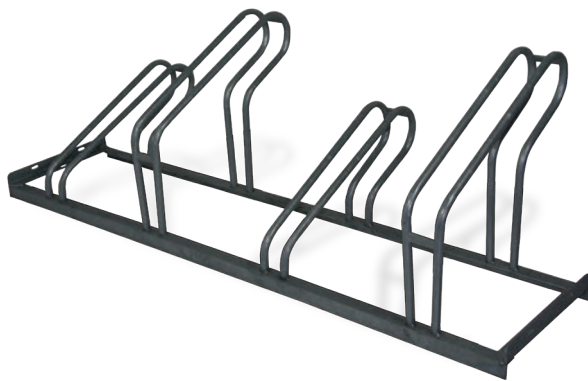
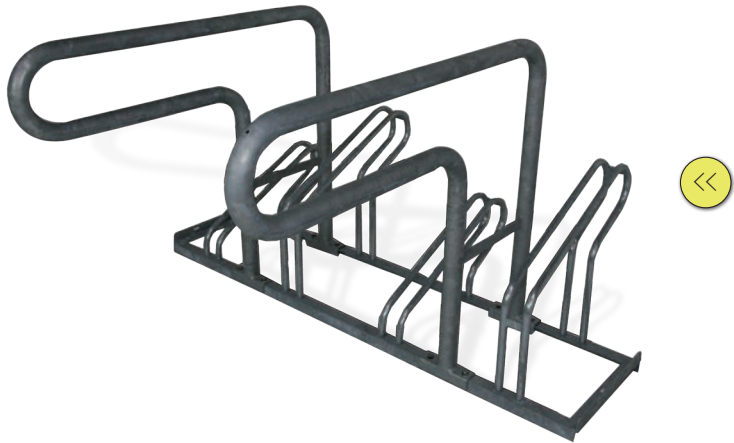

A-11 CYCLE RACK | 00.004.037

A-11(MB) SINGLE SIDED	
PART CODE	DESCRIPTION
00.004.037	4 place, c.t.c. 375mm, length 1,500mm
00.006.037	6 place, c.t.c. 375mm, length 2,250mm
00.008.037	8 place, c.t.c. 375mm, length 3,000mm
00.004.240	4 place, c.t.c. 400mm, length 1,600mm
00.005.240	5 place, c.t.c. 400mm, length 2,000mm
00.006.240	6 place, c.t.c. 400mm, length 2,400mm

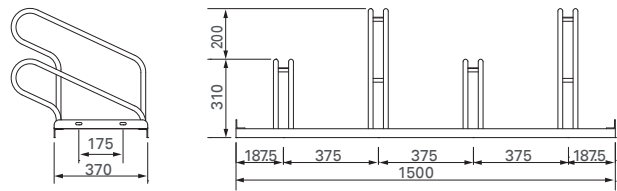

A-11, part code 00.004.037

Single sided racks can be equipped with add-on supports or fastening supports. The protruding section means that the cyclist can remain behind the bicycle. In order to ensure quality, the racks are drilled before hot-dip galvanised; the supports or posts are only fitted afterwards.

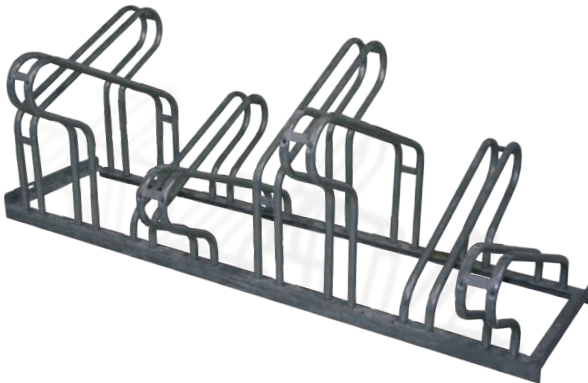

A-11B CYCLE RACK | 00.028.018

A-11B DOUBLE SIDED	
PART CODE	DESCRIPTION
00.028.018	8 place (4 each side), c.t.c. 187.5mm, length 1,500mm
00.032.018	12 place (6 each side), c.t.c. 187.5mm, length 2,250mm
00.028.220	8 place (4 each side), c.t.c. 200mm, length 1,600mm
00.032.220	12 place (6 each side), c.t.c. 200mm, length 2,400mm

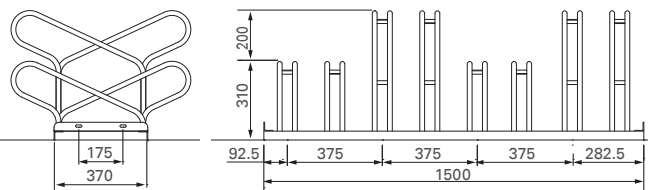

A-11B, part code 00.028.018



FALCOSOUND CYCLE RACK

FALCOSOUND

The FalcoSound is a space saving and user friendly cycle parking system ideal for securing the front wheel of a bicycle. The great flexibility of this cycle rack enables it to meet all applications; whether you’re planning to locate it indoors or outdoors; on the street, in a compound or a basement, the FalcoSound is flexible enough to meet any requirement.

The cycle rack alternates wheel positioning using a high and low system which allows secure accommodation for a maximum number of cycles. Available as a single or double sided version.

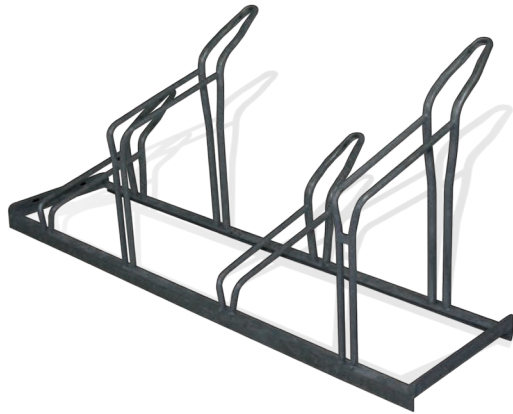

FALCOSOUND CYCLE RACK | 00.104.037

FALCOSOUND SINGLE SIDED	
PART CODE	DESCRIPTION
00.104.037	4 place, c.t.c. 375mm, length 1,500mm
00.106.037	6 place, c.t.c. 375mm, length 2,250mm
00.108.037	8 place, c.t.c. 375mm, length 3,000mm
00.104.040	4 place, c.t.c. 400mm, length 1,600mm
00.106.040	6 place, c.t.c. 400mm, length 2,400mm
00.108.040	8 place, c.t.c. 400mm, length 3,300mm

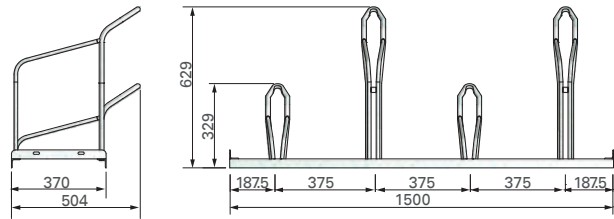

FalcoSound, part code 00.104.037

The cycle rack is optionally available with a locking eye for increased security, allowing the user to secure their own chain or padlock to the frame of the bike.

The protruding section means that the cyclist can remain behind the bicycle. The cycle rack is manufactured from hot-dip galvanised steel and can be optionally powder coated in any of the 192 RAL colours.



FALCOSOUND CYCLE RACK | 00.128.018

FALCOSOUND DOUBLE SIDED	
PART CODE	DESCRIPTION
00.128.018	8 place (4 each side), c.t.c. 187.5mm, length 1,500mm
00.132.018	12 place (6 each side), c.t.c. 187.5mm, length 2,250mm
00.128.020	8 place (4 each side), c.t.c. 200mm, length 1,600mm
00.132.020	12 place (6 each side), c.t.c. 200mm, length 2,400mm

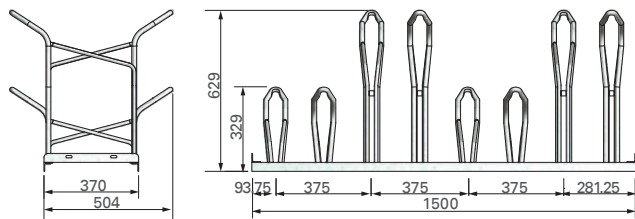

FalcoSound, part code 00.128.018



FALCOSCANDI DOUBLE-SIDED CYCLE RACK

FALCO-DK CYCLE RACK

The Falco-DK cycle rack is one of our most popular cycle rack designs. The design of the wheel support means this cycle rack is suitable for virtually any bicycle, with a spacing of 500mm apart, the Falco-DK provides outstanding stability by clamping the front fork. The cycle rack is made up of two supports, one on either side of the cycle rack (with intermediate supports on longer racks) with individual wheel clamps. The use of intermediate support posts allows the cycle rack to be constructed in a continuous run as far as required.



FALCO-DK CYCLE RACK

FALCOSCANDI CYCLE RACK

The FalcoScandi is similar in design to the Falco-DK cycle rack, but offers a circular wheel support design as opposed to the Falco-DK's triangular support.

Falco-DK and FalcoScandi racks are available in single-, double-sided or wall mounted version.



FALCOSCANDI CYCLE RACK

FALCO-DK/FALCOSCANDI UPRIGHTS	
PART CODE	DESCRIPTION
01.310.010	start/end support, length 1,050mm
01.310.011	start/end support with base plate, length 660mm
01.311.010	intermediary support, length 1,050mm
01.311.011	intermediary support with base plate, length 660mm
01.312.000L	wall support, left
01.312.000R	wall support, right
01.312.100	wall support, intermediary

FALCO-DK RACK, SINGLE SIDED	
PART CODE	DESCRIPTION
01.314.050	4 place, c.t.c. 500mm, length 1,830mm, 90°
01.314.862L	4 place, c.t.c. 625mm, length 2,330mm, 45° left
01.314.862R	4 place, c.t.c. 625mm, length 2,330mm, 45° right
01.315.050	5 place, c.t.c. 500mm, length 2,330mm, 90°
01.315.862L	5 place, c.t.c. 625mm, length 2,955mm, 45° left
01.315.862R	5 place, c.t.c. 625mm, length 2,955mm, 45° right

FALCO-DK RACK, DOUBLE SIDED	
00.328.050	2x4 place, c.t.c. 500mm, length 1,830mm, 90°
00.330.050	2x5 place, c.t.c. 500mm, length 2,330mm, 90°
00.332.050	2x6 place, c.t.c. 500mm, length 2,830mm, 90°

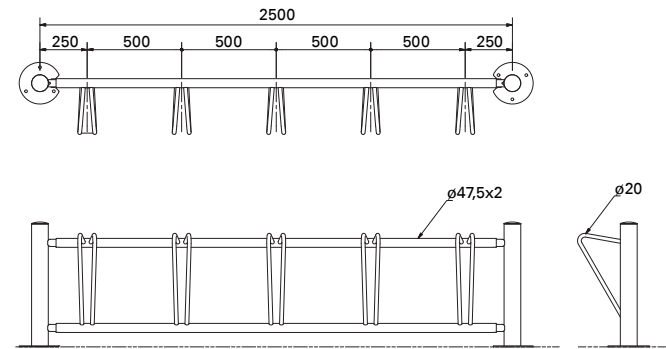

Falco-DK,
2x part code 01.310.011 + 1x part code 01.315.050



FALCO-DK SINGLE RACK, 45°

FALCOSCANDI RACK, SINGLE SIDED	
PART CODE	DESCRIPTION
01.464.050	4 place, c.t.c. 500mm, length 1,830mm, 90°
01.465.050	5 place, c.t.c. 500mm, length 2,330mm, 90°
01.466.050	6 place, c.t.c. 500mm, length 2,830mm, 90°

FALCOSCANDI RACK, DOUBLE SIDED	
00.478.050	2x4 place, c.t.c. 500mm, length 1,830mm, 90°
00.480.050	2x5 place, c.t.c. 500mm, length 2,330mm, 90°
00.482.050	2x6 place, c.t.c. 500mm, length 2,830mm, 90°

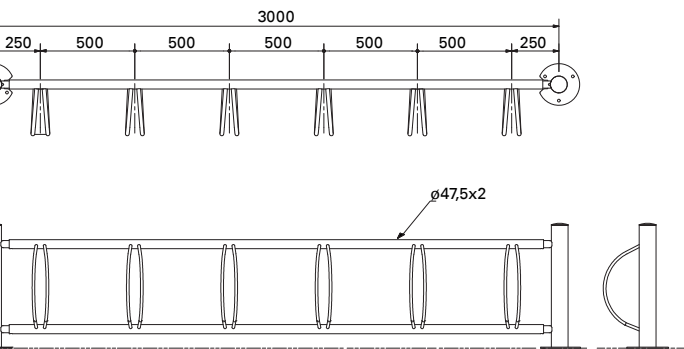

FalcoScandi,
2x part code 01.310.011 + 1x part code 01.466.050



FALCOHANGER CYCLE RACK

A simple cycle parking system ideal for locations where security is not an issue such as private offices and garages. The rack is designed to accommodate 98% of bikes. A protective plastic cover protects the handle bars from scratches.

FALCOHANGER	
PART CODE	DESCRIPTION
00.510.000*	starter/end upright, height 2,220mm, below ground fix
00.510.212*	starter/end upright, height 1,380mm on base plates
00.511.000*	intermediate upright, height 2,220mm, below ground fix
00.511.212*	intermediate upright, height 1,380mm on base plates
00.516.037*	traverse for 6 bikes c.t.c. 375mm, length 2,190mm
00.518.037*	traverse for 8 bikes c.t.c. 375mm, length 2,940mm
00.532.018*	traverse for 2x6 bikes c.t.c. 187.5mm, length 2,310mm
00.536.018*	traverse for 2x8 bikes c.t.c. 187.5mm, length 3,060mm

*All steelwork can be powder coated in any of the 192 standard RAL colours, simply add ‘PC’ to the start of any part code(s) listed.

The rack is available in single and double sided units using a high-low system so that space is used to maximum effect. The single sided version is available in 6 or 8 cycle parking spaces with the double sided version available in 12 or 16 spaces.

FALCOHANGER RACK | 00.518.037

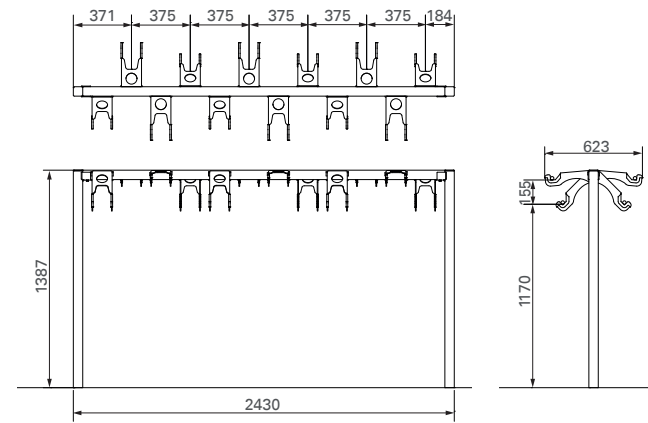

FalcoHanger, part code 00.510.212 (2x) + 00.532.018 (1x)



FALCOTUMBLER

FALCOTUMBLER

The FalcoTumbler is a cycle parking system designed to securely park all types of cycles regardless of wheel or tyre, size or diameter. The cycle rack makes use of a self-adjustable wheel support system, allowing cyclists to adjust the rack to their own cycle requirement.

The FalcoTumbler is a European patented cycle parking system, patent number: 2012755.



With a traditional cycle rack a cycle wheel is secured in three separate places, one either side of the wheel and one in front. However with the FalcoTumbler, there is only one fixed point and two adjustable points, allowing the clamp to always adjust itself to the wheel or tyre diameter.

The FalcoTumbler is available in a single sided variant or a double sided variant.

FALCOTUMBLER	
PART CODE	DESCRIPTION
01.414.037*	single sided, 4 place, c.t.c. 375mm, length 1,500mm
01.414.040*	single sided, 4 place, c.t.c. 400mm, length 1,600mm
01.418.020*	double sided, 2x4 place, c.t.c. 200mm, length 1,600mm

*All steelwork can be powder coated in any of the 192 standard RAL colours upon request, simply add ‘PC’ to the start of any part code(s) listed above.

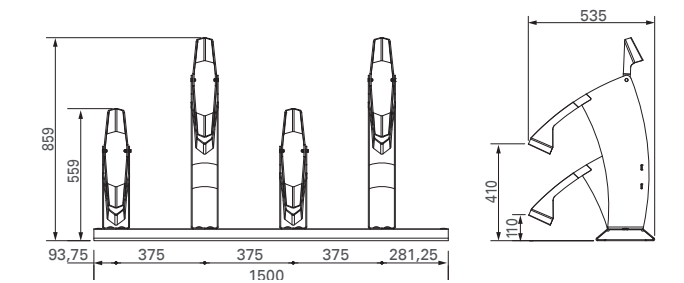

FalcoTumbler, part code 01.414.037



FALCOLEVEL PREMIUM+ IN A FALCOGAMMA 2HI CYCLE COMPOUND <page 172/173>

FALCOLEVEL PREMIUM+

Go Dutch with the FalcoLevel Premium+ a gear change in usability and design. The FalcoLevel Premium+ is an innovative and user friendly cycle parking system which accommodates twice the number of bicycles compared to any other traditional cycle rack or stand.

Manufactured from robust steel and aluminium, it creates a significant reduction in noise pollution, is smoother to operate and is just as easy to park a bike on the upper rack as the lower rack

It can be a real puzzle to park all bikes in the available space. A two tier system is the perfect solution in this situation.

The FalcoLevel Premium+ is available in a centre to centre distance of 375mm or 400mm. To enhance the number of cycle spaces available we advise choosing a 375mm centre to centre distance.



Features

Some key features of the FalcoLevel Premium+ arise from it's development cycle:

- The FalcoPremium+ has excellent build quality, typical of a Falco product.
- Utilises 'Stabilus' gas struts (world market leader in gas struts as used in the automotive industry).
- Rollers are manufactured from hard wearing nylon with a stainless steel bearing.
- Adjustable feet for uneven surfaces.
- Each space can be provided with a number, symbol or charactor upon request.
- A catch prevents the rack from sliding backwards.



Benefits

Compared to traditional two tier cycle parking systems, the aluminium FalcoLevel Premium+ two tier cycle rack from Falco, has some distinct benefits over its rivals:

- Significant sound reduction from upper tier removing a large amount of noise pollution.
- Smoother action for the storage and retrieval of bikes.
- Just as easy to park a bicycle on the upper rack as the lower rack.
- Better suited for modern bikes with higher and wider handle bars.
- Connect multiple units side by side for as long as required.
- Available as a single or double sided version.
- Suitable for cycle tyres with a thickness of 27-50mm.
- Lighter to use than steel units making upper tier available to more cyclists.
- Ergonomic handgrip, with a thicker, warm to touch material that can be lifted with one or two hands.
- Lower lifting height (of the bike into the gutter).
- The roll in angle of the bike is less steep.
- Integrated floating feet for mounting on uneven surfaces.
- Modular design enables flexible c.t.c. bike spacing measurements.
- Stylish looking modern European design.
- Has multiple locking points for differing cycle designs.
- Robust welded construction for steel framework - hot dip galvanised to BS EN ISO 1461 and available in 192 RAL colours).
- Modular design enables flexible c.t.c. bike spacing measurements.
- Robust welded construction for steel framework - hot dip galvanised to BS EN ISO 1461 and available in 192 RAL colours).



Optional locking points

There are two optional locking systems to secure a bike to the FalcoLevel-Premium+ two-tier cycle rack:

- Locking point to be bolted on: to provide additional security for cycles. Available for the lower and higher spaces. Can only be provided for new racks.

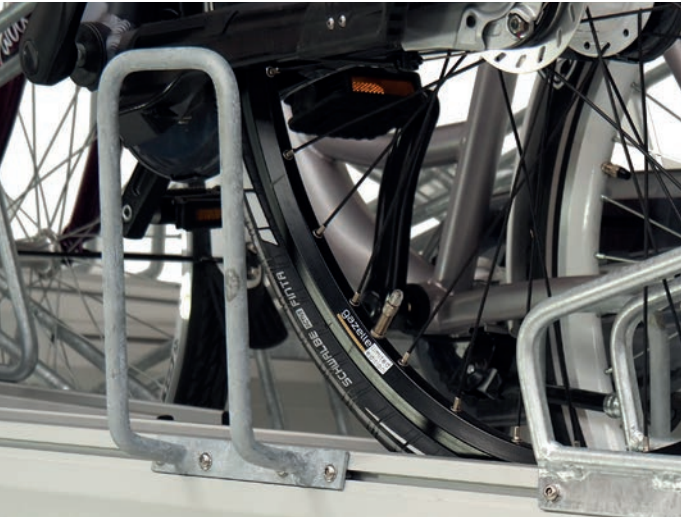

- Lower locking point: to provide additional security for cycles parked on the lower racks with a centre to centre distance of 400mm, a secure locking mount can be supplied. This secure locking mount can be provided for both new racks and existing racks.



Other options

- Upright Cover Plate: An upright end cover plate can be supplied upon request for cycle parking areas unable to expand using standard add-on sections.
- Cycle Space Identification: Each cycle parking space can be allocated with a number or company logo or scheme to identify individual cycle parking spaces.



FALCOLEVEL PREMIUM+	
PART CODE	DESCRIPTION
00.354.040	single sided FalcoLevel Premium+, 4 places in upper - and 4 places in the lower tier, c.t.c. 400mm, length 1,643mm
00.372.020	double sided FalcoLevel Premium+, 12 places in upper - and 12 places in the lower tier, c.t.c. 200mm, length 2,443mm

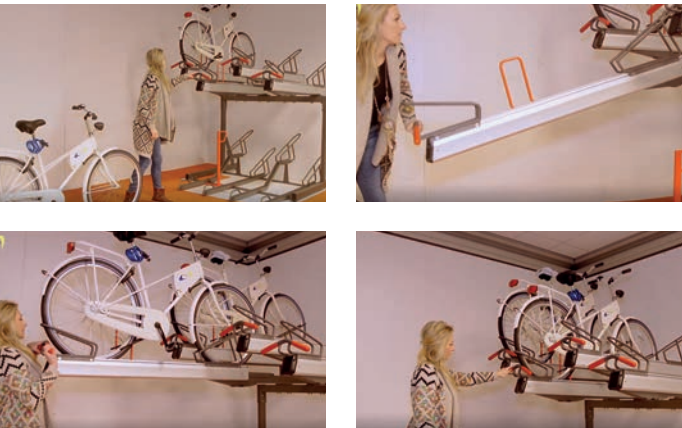

The FalcoLevel Premium+ is suitable for indoor or outdoor use. Falco also manufacture a range of single sided and double sided shelter and canopy structures ideal for sheltering the two-tier system.

FALCOLEVEL PREMIUM+, OPTIONAL	
PART CODE	DESCRIPTION
00.352.000H	loose provision to be bolted on for two point locking of the bike, for the upper level
00.352.000L	loose provision to be bolted on for two point locking of the bike, for the lower level
00.352.040L	lower rack locking point, security for cycles parked on the lower racks
OND00.350.310	FalcoLevel Premium+ upright cover plate

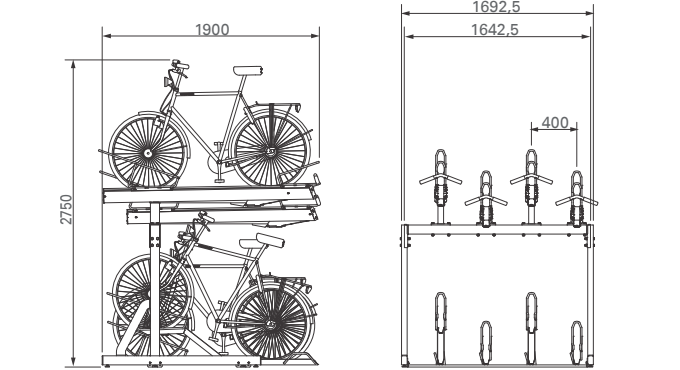

FalcoLevel Premium+, part code 00.354.040



FALCOVERT

FALCOVERT

The FalcoVert is a space saving cycle rack design ideal for highly popular densities such as stations, cycle hubs, shopping centres, high streets and car parks etc.

The FalcoVert is a compact cycle parking system which securely parks bicycles in a semi vertical position with both front and rear wheels located in a custom designed trough.



- Features and Benefits of the FalcoVert cycle rack include:
- Suitable to store all types of bicycles - from racing bikes to mountain bikes and bikes with extra wide tyres
 - Can accommodate any number of cycles
 - Fully locates both wheels in a custom designed tapered steel trough
 - Available in a single or double sided variant

FALCOVERT	
PART CODE	DESCRIPTION
00.564.030	4 place, c.t.c. 305mm, length 1,220mm
00.564.040	4 place, c.t.c. 400mm, length 1,600mm
00.566.030	6 place, c.t.c. 305mm, length 1,830mm
00.566.040	6 place, c.t.c. 400mm, length 2,400mm

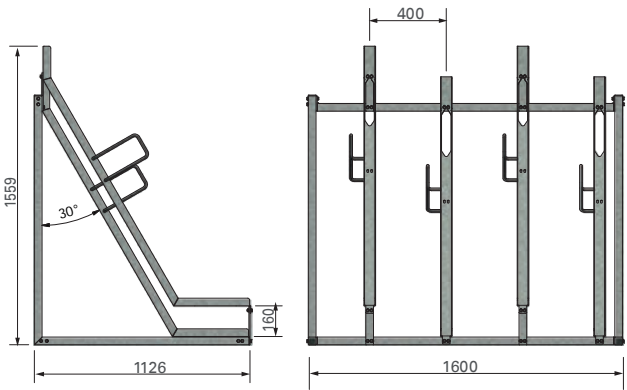

FalcoVert, part code 00.564.040



FALCOMAT WALL STAND

The FalcoMat is a very popular wall mounted cycle parking unit and a great space saving solution. Using an ingenious gas strut assisted mechanism, the FalcoMat makes vertical mounting of cycles very easy. Simply attach the front wheel to the hook, pull the bicycle towards you and the bicycle is automatically raised! Robust, secure and space saving, the FalcoMat is easily mounted onto the wall with just two bolts.

FALCOMAT	
PART CODE	DESCRIPTION
01.900.000	wall stand for one bicycle

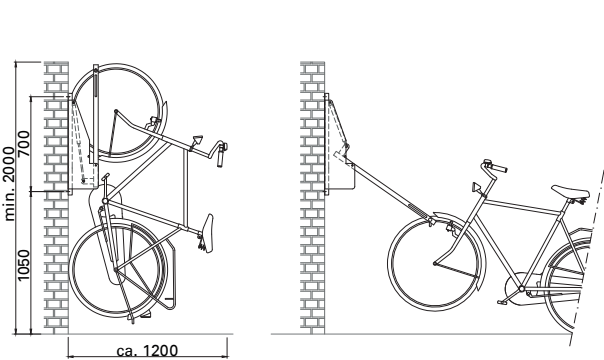

FalcoMat, part code 01.900.000



FALCO HANGING RAIL

The Falco Hanging Rail system consists of 4 stainless steel hooks mounted on a rail. Bicycles can be suspended by their front wheel from the hooks. The rail can be secured to a wall or ceiling by means of 2 supports.

Because the bicycles are suspended, little depth is needed. This makes the hanging rail extremely suitable for smaller spaces such as cellars, sheds and garages.

FALCO HANGING RAIL	
PART CODE	DESCRIPTION
01.094.000	complete set for mounting to a ceiling
01.094.100	complete set for mounting to a wall

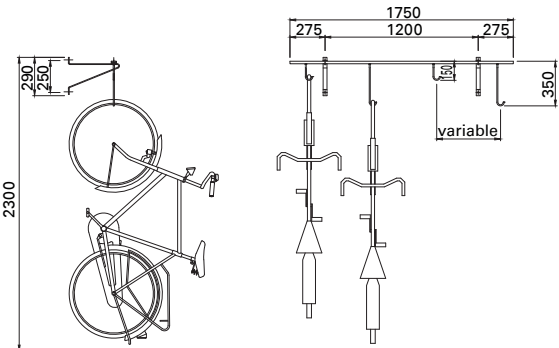

Falco Hanging Rail, part code 01.094.100



F-7 CYCLE CLAMP

F-7 AND F-8 CYCLE CLAMPS

Cycle clamps are general purpose, floor mounted, low cost solutions for areas where vandalism and theft are not an issue. A great economical way to provide cycle parking in mass numbers where standard leaning hoops such as Sheffield stands are not appropriate.



F-7 | 01.160.xxx F-8 | 01.162.xxx

The F-7 clamp is a heavy duty single cycle clamp made of solid Ø20mm steel. Hot-dip galvanised. Equipped with 120mm anchor piece or with concrete block for insertion into ground.

The F-8 is a double sided version of the F-7 cycle clamp. Both models are available with or without a concrete base.

F-7 AND F-8 CLAMP	
PART CODE	DESCRIPTION
01.160.000	F-7 single clamp, with 120mm anchor piece
01.160.171	F-7 single clamp, with 200mm anchor piece
01.160.100	F-7 single clamp, with concrete base
01.162.000	F-8 double clamp, with 150mm anchor piece
01.162.171	F-8 double clamp, with 200mm anchor piece
01.160.100	F-7 single clamp, with concrete base

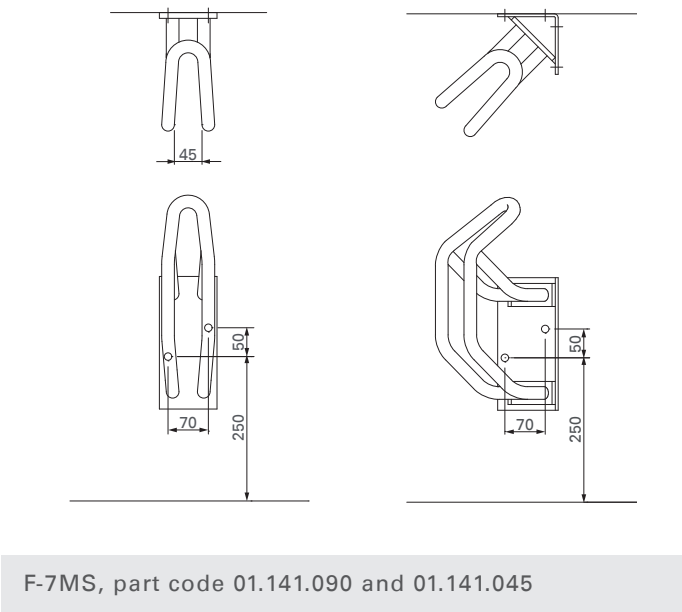
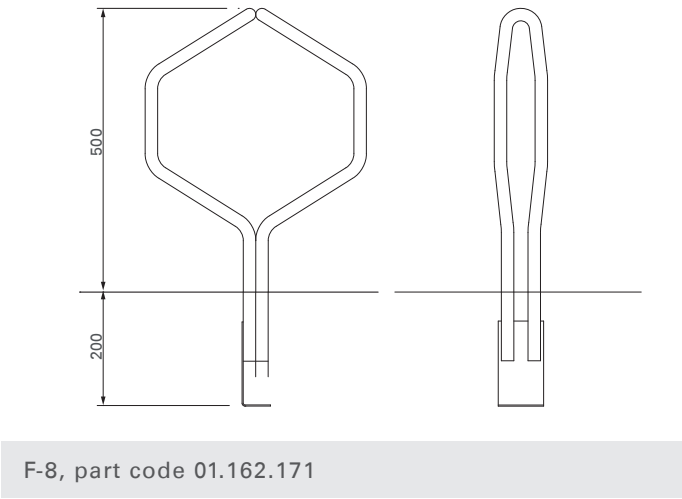
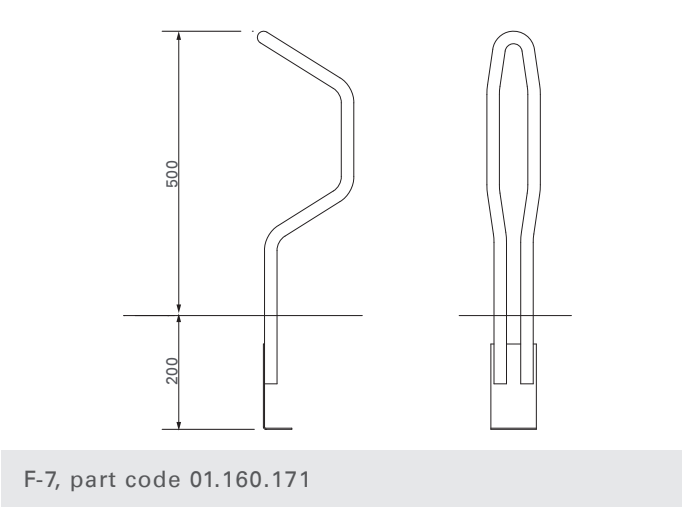

F-7MS | 01.141.090

F-7MS/F-7MSB WALL CLAMP

Heavy duty cycle wall clamp made of solid Ø20mm welded steel onto a 230x100mm mounting plate which is 8mm thick and has been hot-dip galvanised.

Equipped with 2 fixing holes of Ø13mm diameter. Available in 90° and 45°. We recommend that the clamps are fitted at a centre to centre distance of 750mm at 90° and 1060mm at 45°. The centre of the clamp should be mounted 350mm above the ground.

The F-7MSB is the variant suitable for accommodating mountain bikes.

F-7MBS WALL CLAMP	
PART CODE	DESCRIPTION
01.141.090	F-7MS wall clamp 90°
01.141.045	F-7MS wall clamp 45°
01.148.090	F-7MBS wall clamp 90°
01.148.045	F-7MBS wall clamp 45°



F-1 90° CLAMP

F-1 WALL CLAMP

A sturdy cycle wall clamp with wheel supports made of solid Ø12mm steel. Hot-dip galvanised to BS EN ISO 1461. Available in 90° and 45°.

We recommend that the clamps are fitted at a centre to centre distance of 650mm at 90° and 920mm at 45°. The centre of the clamp should be mounted 350mm above the ground. Stainless steel mounting bolts can be ordered separately.

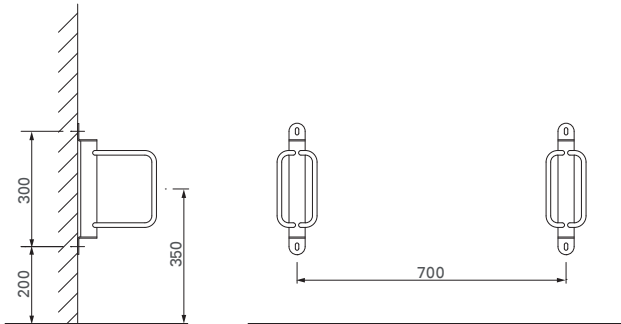

F-1, part code 01.120.090

F-1 WALL CLAMP	
PART CODE	DESCRIPTION
01.120.090	F-1 wall clamp 90°
01.120.045	F-1 wall clamp 45°



F-1 45°



FALCOCRATE

The FalcoCrate is a purpose designed cycle rack to accommodate bicycles with integrated storage baskets. This style of bike requires a wider length to prevent each cycle from clashing side by side and subsequently the FalcoCrate has been purposely designed to provide a secure and userfriendly solution.

The FalcoCrate makes use of a high/low design allowing cycles to be accommodated closer together without any handlebars or baskets clashing. The innovative design prevents bicycles from rolling backwards.

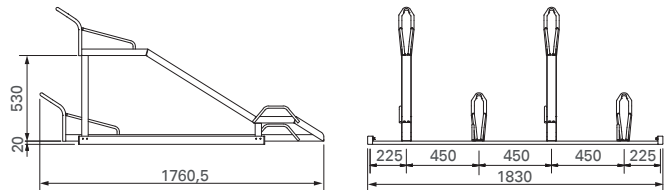

FalcoCrate, part code 01.154.045



The cycle rack has a centre to centre distance of 450mm with a 530mm low/high height different.

FALCOCRATE	
PART CODE	DESCRIPTION
01.153.045	3 place, c.t.c. 450mm, length 1,380mm
01.154.045	4 place, c.t.c. 450mm, length 1,830mm
01.156.045	6 place, c.t.c. 450mm, length 2,730mm



FALCOFIX 2.0 CYCLE STATION

The FalcoFix 2.0 transforms a traditional bicycle pump into a convenient repair and maintenance station for all types of bikes. Ideal for stations, cycle hubs and other dedicated cycle parking facilities, the FalcoFix 2.0 features a number of useful tools to carry out basic cycle maintenance.

The bicycle simply hangs by resting the seat post in between the station support arms, allowing full motion of the wheels and the pedals. A rubber coating to the support arms prevents any scratches to the bike.

From gear and brake adjustment to tyre inflation, the FalcoFix 2.0 features a number of useful tools to carry out basic cycle maintenance. The FalcoFix 2.0 is seperated into two different parts to increase usability.

FALCOFIX 2.0	
PART CODE	DESCRIPTION
01.994.000*	cycle station, 1,407mm tall
96.245.450	concrete securing block for below ground level

*All steelwork can be powder coated in any of the 192 standard RAL colours upon request, simply add 'PC' to the start of any part code(s) listed to the left.

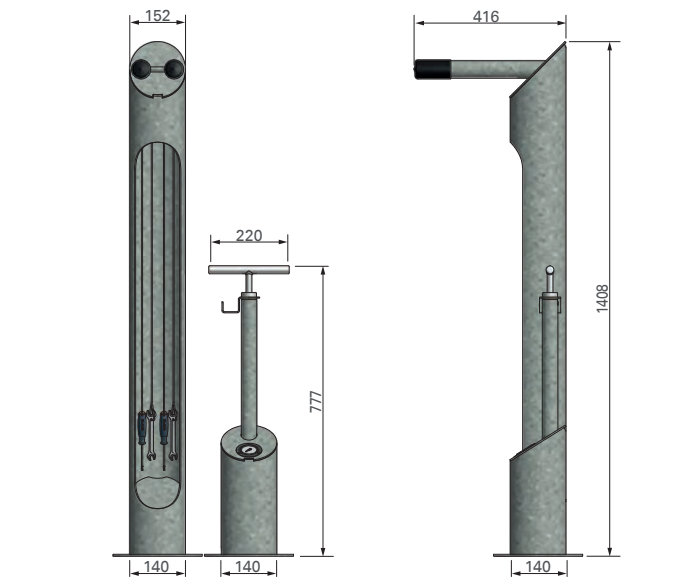

FalcoFix 2.0, part code 01.964.000



FALCOBOOST CYCLE PUMP

The FalcoBoost is a heavy-duty cycle pump design, enabling cyclists to quickly and conveniently inflate their bicycle tyres. With cycling growing in popularity every day, the FalcoBoost lends a helping hand to ensure bicycles are suitable for riding. The FalcoBoost is positioned at a slight angle to allow greater visibility for the cyclist to view the pressure gauge.

The FalcoBoost can incorporate text or brand logos to add to the feel of a cycling campaign or brand identity. The pump features a universal adapter compatible with all types of bicycles with a protective layer making it ideal for public use.

The FalcoBoost features a welded base plate for surface fixing into concrete. Alternatively the FalcoBoost can be supplied with a concrete block for insertion into the ground.

FALCOBOOST	
PART CODE	DESCRIPTION
01.991.000*	cycle pump with pressure gauge, with welded base plates, 692mm high
96.245.450	concrete securing block for below ground level

*All steelwork can be powder coated in any of the 192 standard RAL colours upon request, simply add 'PC' to the start of any part code(s) listed to the left.

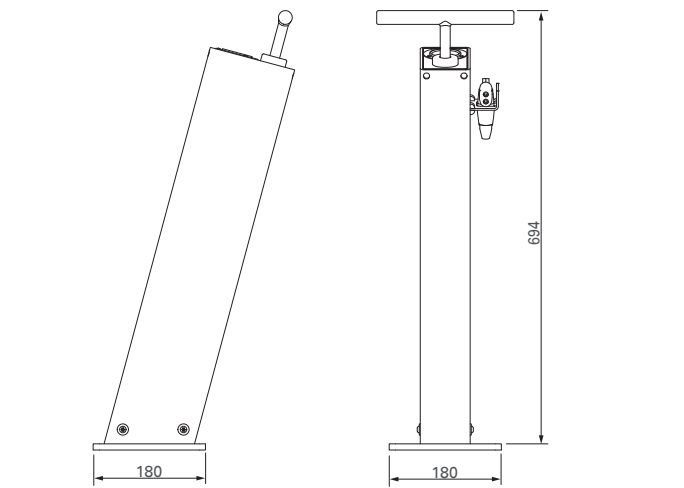

FalcoBoost, part code 01.991.000





FALCOSAFE CYCLE LOCKERS

FALCOSAFE CYCLE LOCKER

The FalcoSafe locker is a robust and secure cycle storage unit and comes in two standard sizes; one for cycles and one for mopeds.

The perforated sides mean that the contents remain visible for security whilst providing ventilation. Side wall perforated panels are contoured for extra strength.

The individual design is completed with a gable roof; to deter roof access.

A huge variety of attractive colour combinations are available for the FalcoSafe locker using any of the 192 RAL colours.

The standard locker is suitable for securing with a user’s padlock but a number of other locking options are available including; coin return, coin retain and Euro-profile lock options.

The bicycle is supported in the locker along a channel up to a cycle clamp. Any number of cycle lockers can be linked together. In addition, the lockers can also be positioned back to back.

FALCOSAFE	
PART CODE	DESCRIPTION
01.801.000	FalcoSafe cycle locker, starter for 1 bicycle, in perforated profiled steel plate, door with facility for padlock
01.801.031	FalcoSafe cycle locker, starter for 1 bicycle, in perforated profiled steel plate, door with dead- lock W453H, incl. europrofile cylinder +3 keys
01.805.000	FalcoSafe cycle locker, add-on for 1 bicycle: in perforated profiled steel plate, door with facility for padlock
01.805.031	FalcoSafe cycle locker, add-on for 1 bicycle: in perforated profiled steel plate, door with dead- lock W453H & cylinder & 3 keys, excl. cylinder
01.821.000	FalcoSafe moped locker, starter for 1 moped, in perforated profiled steel plate, door with facility for padlock
01.825.000	FalcoSafe moped locker, add-on for 1 moped: door with facility for padlock, back wall, one side wall of perforated profiled steel plate

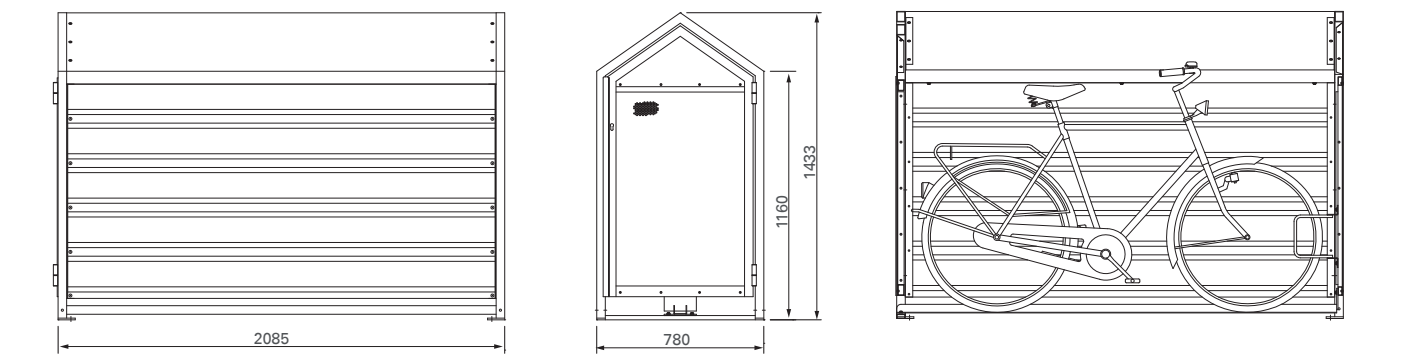

FalcoSafe, part code 01.801.000

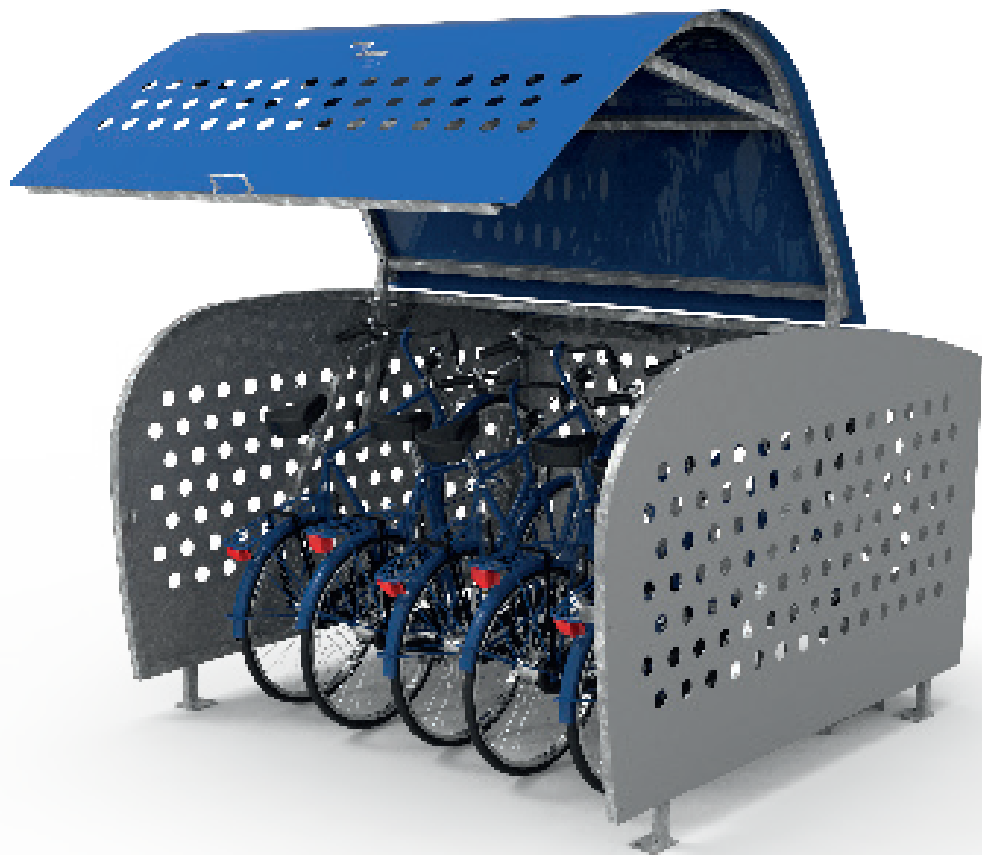

FALCOCASE CYCLE LOCKER

FALCOCASE CYCLE LOCKER

The FalcoCase is the perfect solution for securely housing up to 5 bikes at offices, housing estates or where renting is a requirement

Operating like a giant breadbin, the FalcoCase is cylindrical in design with an upward moving, curved door at the front. The door is equipped with gas struts to facilitate the process of opening.

The door is supplied with a Europrofile cylinder lock for additional security.

The FalcoCase has a smooth curvaceous design with a perforated door and side walls providing visibility and maximum ventilation.

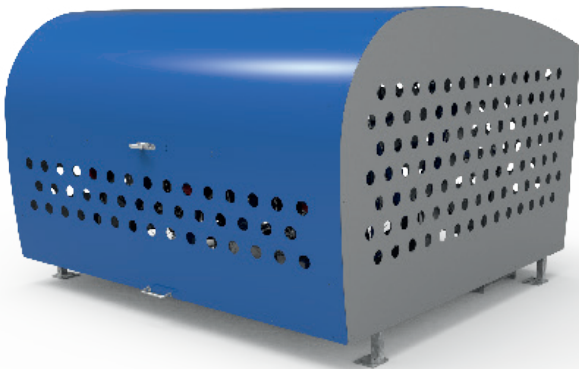

A huge variety of attractive colour combinations are available for the FalcoCase design using any of the 192 standard RAL colours. The door and the side walls can be powder coated in separate colours.

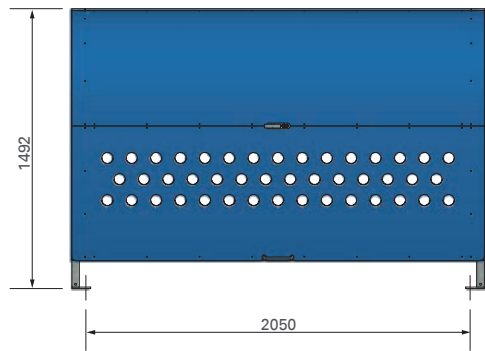

FALCOCASE	
PART CODE	DESCRIPTION
01.910.000	FalcoCase cycle locker, for 5 bicycles, sheeting powdercoated in RAL ____
PC01.910.000	FalcoCase cycle locker, for 5 bicycles, steel construction powdercoated in RAL ____
00.805.037	Ideal 2.0 single-sided bicycle rack, 5 place, c.t.c. 375mm, length 1,875mm
00.105.037	FalcoSound single-sided bicycle rack, 5 place, c.t.c. 375mm, length 1,875mm

The FalcoCase can accommodate up to 5 bikes using the recommended FalcoSound cycle rack see page 120/121 or the Ideal 2.0 cycle rack see page 124/125 (cycle racks sold separately).

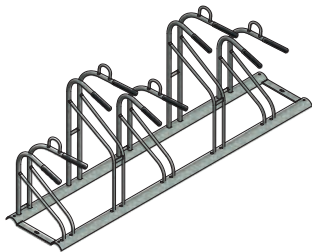

Ideal cycle rack

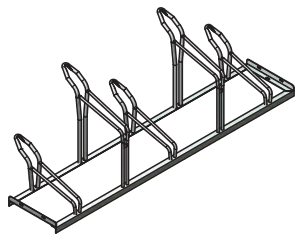

FalcoSound cycle rack

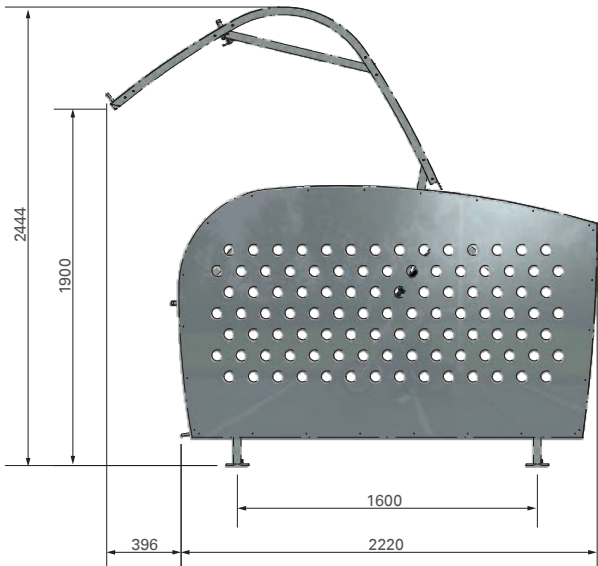

FalcoCase, part code 01.910.000